

## INSTALLATION - FLUSH MOUNT

- 1** Select a mounting location and drill an 1" (25.4mm) cut-out.

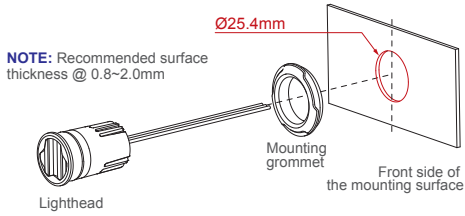

- 2** From the front, install the MOUNTING GROMMET onto the cut-out, and insert the LIGHTHEAD.

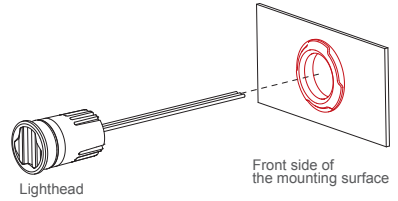

- 3** Ensure that the optical stripes are aligned vertically.

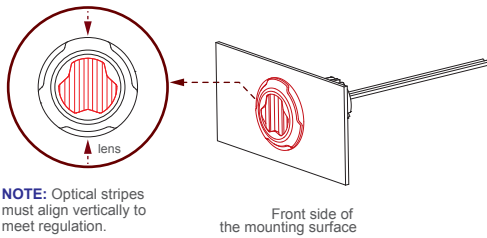

- 4** Where necessary, apply silicone around the reverse side to prevent from rotating.

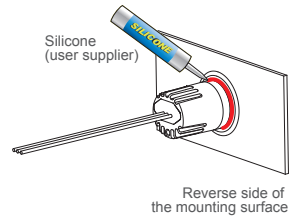

## INSTALLATION - BRACKET MOUNT (sold-separately)

- 1** From the front, install the MOUNTING GROMMET onto the BRACKET, and insert the LIGHTHEAD.

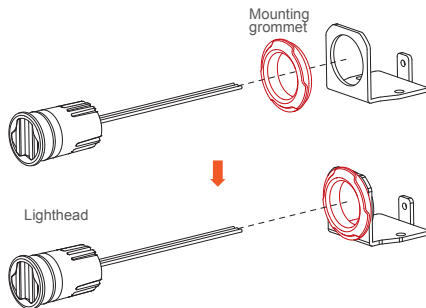

- 2** Ensure that the optical stripes are aligned vertically.

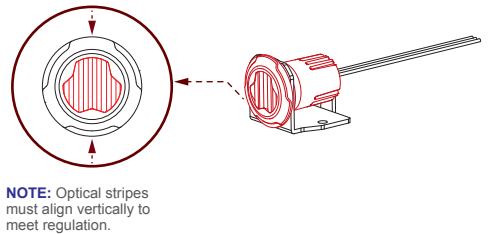

- 3** Secure the LIGHTHEAD onto the BRACKET with a screw.

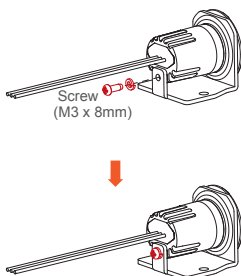

- 4** Secure the BRACKET onto the desired mounting surface with screws.

